

# 21-29

W. EASY STREET  
SIMI VALLEY, CALIFORNIA



## For Sublease

3,678 S.F. INDUSTRIAL FOR SUBLEASE

FOR INFORMATION,  
CONTACT:

### GRANT FULKERSON, SIOR

Principal  
818.304.4956  
CA License #01483890

### ERICA BALIN

Principal  
818.444.4912  
CA License #01481476

## Multi-Tenant Industrial Property

- High Image Professional Business Park
- Strategically Located Along Main Thoroughfare
- Gated Site Providing Additional Security
- Immediate Access to Highway 118 Via Madera Rd
- Near Numerous Retail Amenities
- Impressive Clearance Heights
- Zoned GI-SP



**LEE & ASSOCIATES**  
COMMERCIAL REAL ESTATE SERVICES  
Corporate ID #01191898

# Industrial for Sublease

- **Total SF:** 3,678
- **Whse SF:** 1,871
- **Ground Level Office SF:** 849
- **Mezzanine Level Office SF:** 958
- **Loading:** 1 GL
- **Lease Rate:** \$1.41 PSF MG\*

\*Plus a \$0.11. per square foot estimated Common Area Maintenance (CAM) fee

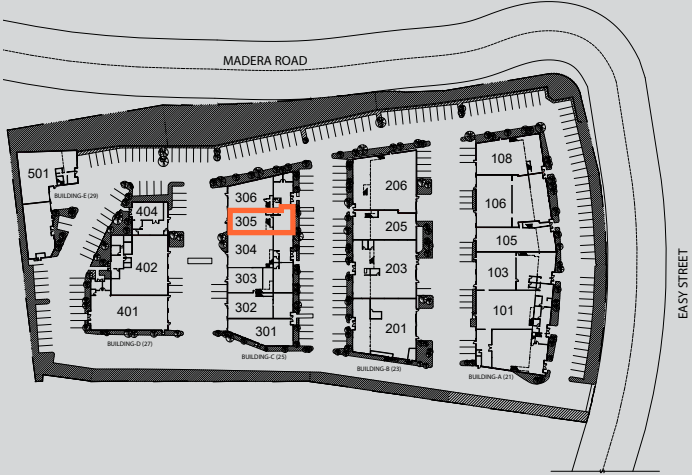
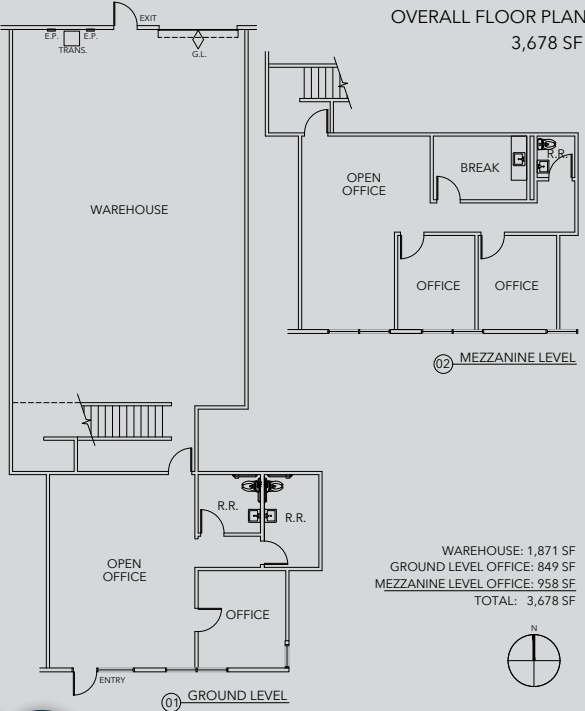

# For Sublease

25 W. EASY STREET, UNIT 305, SIMI VALLEY, CA

VENTURA COUNTY

